



****AVAILABLE JULY 2026****

****UNFURNISHED**** A very well presented, two bedroom ground floor 'Tyneside' flat ideally located on the west backing side of Sandringham Road, South Gosforth. In a great location, only a stone's throw away from The Brandling Villa, Sainsbury's Local, South Gosforth Metro Station and Jesmond Dene. The local shops and amenities of Station Road and Gosforth High Street are also only a short walk away!

The accommodation briefly comprises: entrance lobby through to entrance hall; lounge with feature fireplace and stripped wood flooring; kitchen with fitted wall and base units, wood work surfaces and appliances, with doors to both the bathroom and rear yard; bathroom WC, fully tiled with three piece suite; both bedrooms have stripped wood flooring, with a generous storage cupboard in bedroom two. Externally, a west facing enclosed rear yard, block paved with fence boundaries and gated access to the rear service lane. With double glazed windows and gas central heating, this great property is perfect for professionals, an early viewing is highly recommended!

Available 10th July 2026 | £1,100pcm | Unfurnished | Ground Floor 'Tyneside' Flat | 654 Sq ft (60.7m²) | Two Bedrooms | West Facing Enclosed Rear Yard | Kitchen | Period Features | Well Presented Throughout | GCH & DG | Great Location | Council Tax Band: A | EPC Rating: D



GROUND FLOOR
654 sq.ft. (60.7 sq.m.) approx.

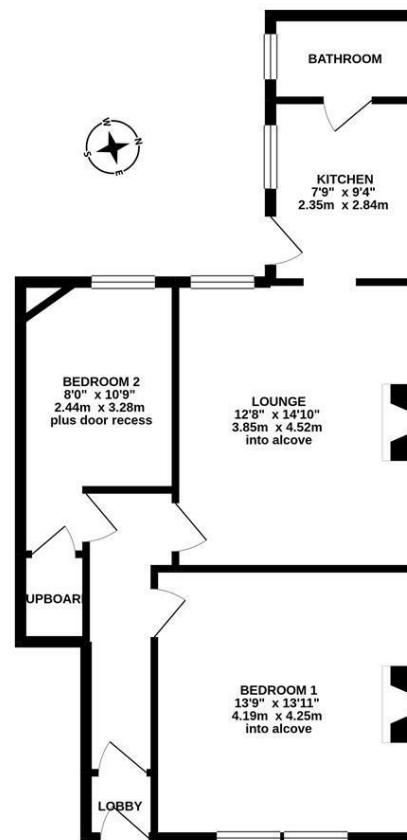

TOTAL FLOOR AREA: 654 sq.ft. (60.7 sq.m.) approx.

Whilst every attempt has been made to ensure the accuracy of the floorplan contained here, measurements of doors, windows, rooms and any other items are approximate and no responsibility is taken for any error, omission or mis-statement. This plan is for illustrative purposes only and should be used as such by any prospective purchaser. The services, systems and appliances shown have not been tested and no guarantee as to their operability or efficiency can be given.
Made with Metropo ©2020

£1,100 PCM

IMPORTANT NOTE: These particulars and the descriptions and measurements herein do not constitute representation and whilst every effort has been made to ensure accuracy, this cannot be guaranteed.

